

## XSU crossed roller slewing bearing

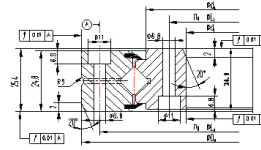
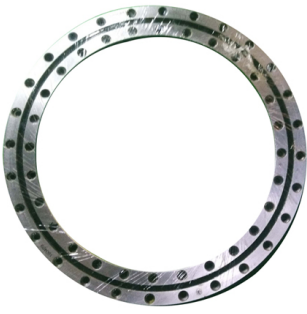

Identification number	Main dimensions						Basic load rating		Tragfähigkeit		weight	
	inner ring d mm	outer ring D mm	width B mm	Installing hole	Chamfer r mm	$\phi L_a$	$\phi L_i$	axial Ca KN	(radial) C0a KN	Kr KN		Kor KN
XSU080168	130	205	25.4	12	1.1	190	145	66	240	42	96	3.3
XSU080188	150	225	25.4	16	1.1	210	165	71	275	46	110	3.7
XSU080218	180	255	25.4	20	1.1	240	195	77	315	49	127	4.3
XSU080258	220	295	25.4	24	1.5	280	235	84	375	54	151	5.1
XSU080318	280	355	25.4	28	1.5	340	295	93	465	59	185	6.3
XSU080398	360	435	25.4	36	2	420	375	106	590	68	236	7.8
XSU140414	344	484	56	24	2	460	368	229	520	146	250	28
XSU140544	474	614	56	32	2.5	590	498	270	680	170	330	38
XSU140644	574	714	56	36	2.5	690	598	290	800	185	395	44
XSU140744	674	814	56	40	3	790	698	315	930	200	455	52
XSU140844	744	914	56	40	3	890	798	340	1050	215	510	60
XSU140944	874	1014	56	44	3	990	898	360	1170	227	580	67
XSU141094	1024	1164	56	48	4	1140	1048	390	1360	246	670	77