

Flexible bearing

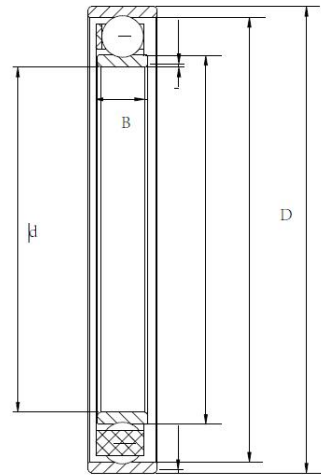

Lager	Inner ring	Outer ring	Breite	Dynamic load rating	Static load rating	Radial Deformation	Input rotate speed	Output torque
Modell	ID	OD	D	Kr	Kor	Max. mm	r (Min.)	N.m
3E904KAT2	18.8	25	4	3.75	3.12	0.2	3000	2
3E905KAT2	24	32	5	4.74	3.75	0.2	3000	6
3E806KAT2	30	40	6	7.12	5.83	0.3	3000	16
1000907AKIT2	35.8	48.2	8	9.93	8.36	0.3	3000	30
3E907KAT2	37	50	8	12.63	12	0.3	3000	30
3E809KAT2	45	60	9	12.89	11.55	0.4	3000	50
1000809AKIT2	45.7	61.8	9.5	12.89	11.55	0.4	3000	50
10008810AKT2	48	63	9.7	12.89	11.55	0.4	3000	50
1000912AKT2	60	80	12	27.19	28.18	0.5	3000	120
3E911KAT2	57	75	12	14.76	13.18	0.5	3000	7.5
3E812KAT2	60	80	13	15.51	14.44	0.5	3000	12
3E814KAT2	70	95	15	22.38	21.57	0.6	3000	20
3E815KAT2	75	100	15	26.4	25.67	0.6	3000	25
3E816KAT2	71	95	15			0.8		
3E818KAT2	90	120	18	34.7	34.94	1	3000	45
3E822KAT2	110	150	24	43.55	45.63	1	1500	80
3E824KAT2	120	160	24	57.02	57.75	1	1500	120
3E826KAT2	130	175	30	81.59	86.1	1	1500	170

Flexible bearing

3E830KAT2	150	200	30	91.6	102.67	1	1500	200	
3E832KAT2	160	220	35	115.66	127.59	1.25	1500	220	
3E836KAT2	180	240	35	130.04	146.47	1.5	1500	250	
3E838KAT2	190	250	40	139.96	160.42	1.5	1500	350	
3E842KAT2	210	280	45	173.15	210.91	1.5	1500	400	
3E844KAT2	220	300	45	181.72	231	1.5	1500	500	
3E848KAT2	240	320	48	190.2	231	2	1500	560	
F14	25.07	33.896	6.095	4.74	3.75	0.2	3000	8	
M14	25.07	33.896	6.095	5.53	4.73	0.2	3000	12	
F17	30.3	41.722	6.16	7.12	5.83	0.3	3000	16	
M17	30.3	41.722	6.16	8.31	7.35	0.3	3000	24	
F20	35.56	49.073	7.24	9.93	8.36	0.3	3000	30	