

Track runner bearings

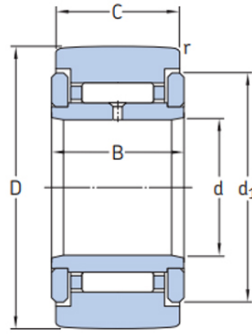

| Bezeichnung fünfzehn fünfzehn | | Dimensions | | | | | | | | Tragzahlen (kN) | | Fatigue load limit (kN) | Maximum radial forces (kN) | | Limiting speed (r/min) | Masse (kg) | Delivery Drawing | Original | Package Brand |
|-------------------------------|----|------------|--------|--------|--------|---------|----------|---------|---------|-----------------|------|-------------------------|----------------------------|-------|------------------------|------------|------------------|------------|---------------|
| | | D (mm) | d (mm) | C (mm) | B (mm) | d1 (mm) | r (Min.) | r1,2min | dynamic | static | Pu | dynamic | static | Fr | For | | | | |
| NATR 5 | 16 | 5 | 11 | 12 | 12.5 | 0.15 | - | 3.14 | 3.2 | 0.345 | 2.9 | 4.15 | 6000 | 0.014 | 7-35 days | Available | China | Single box | MONTON |
| NATR 5 PPA | 16 | 5 | 11 | 12 | 12.5 | 0.15 | - | 3.14 | 3.2 | 0.345 | 2.9 | 4.15 | 6000 | 0.014 | 7-35 days | Available | China | Single box | MONTON |
| NATV 5 | 16 | 5 | 11 | 12 | 12.5 | 0.15 | - | 4.73 | 6.55 | 0.72 | 4.05 | 5.7 | 4300 | 0.015 | 7-35 days | Available | China | Single box | MONTON |
| NATV 5 PPA | 16 | 5 | 11 | 12 | 12.5 | 0.15 | - | 4.73 | 6.55 | 0.72 | 4.05 | 5.7 | 4300 | 0.015 | 7-35 days | Available | China | Single box | MONTON |
| NATR 6 | 19 | 6 | 11 | 12 | 15 | 0.15 | - | 3.47 | 3.8 | 0.415 | 3.8 | 5.5 | 5600 | 0.019 | 7-35 days | Available | China | Single box | MONTON |
| NATR 6 PPA | 19 | 6 | 11 | 12 | 15 | 0.15 | - | 3.47 | 3.8 | 0.415 | 3.8 | 5.5 | 5600 | 0.02 | 7-35 days | Available | China | Single box | MONTON |
| NATV 6 | 19 | 6 | 11 | 12 | 15 | 0.15 | - | 5.28 | 8 | 0.88 | 5.1 | 7.35 | 4000 | 0.021 | 7-35 days | Available | China | Single box | MONTON |
| NATV 6 PPA | 19 | 6 | 11 | 12 | 15 | 0.15 | - | 5.28 | 8 | 0.88 | 5.1 | 7.35 | 4000 | 0.021 | 7-35 days | Available | China | Single box | MONTON |
| NATR 8 | 24 | 8 | 14 | 15 | 19 | 0.3 | - | 5.28 | 6.1 | 0.695 | 5.2 | 7.35 | 5000 | 0.041 | 7-35 days | Available | China | Single box | MONTON |
| NATR 8 PPA | 24 | 8 | 14 | 15 | 19 | 0.3 | - | 5.28 | 6.1 | 0.695 | 5.2 | 7.35 | 5000 | 0.038 | 7-35 days | Available | China | Single box | MONTON |
| NATV 8 | 24 | 8 | 14 | 15 | 19 | 0.3 | - | 7.48 | 11.4 | 1.32 | 7.35 | 10.4 | 3600 | 0.042 | 7-35 days | Available | China | Single box | MONTON |
| NATV 8 PPA | 24 | 8 | 14 | 15 | 19 | 0.3 | - | 7.48 | 11.4 | 1.32 | 7.35 | 10.4 | 3600 | 0.041 | 7-35 days | Available | China | Single box | MONTON |
| NATR 10 | 30 | 10 | 14 | 15 | 23 | 0.6 | - | 6.44 | 8 | 0.88 | 7.8 | 11.2 | 4800 | 0.064 | 7-35 days | Available | China | Single box | MONTON |
| NATR 10 PPA | 30 | 10 | 14 | 15 | 23 | 0.6 | - | 6.44 | 8 | 0.88 | 7.8 | 11.2 | 4800 | 0.061 | 7-35 days | Available | China | Single box | MONTON |
| NATV 10 | 30 | 10 | 14 | 15 | 23 | 0.6 | - | 8.97 | 14.6 | 1.66 | 11 | 15.6 | 3200 | 0.065 | 7-35 days | Available | China | Single box | MONTON |
| NATV 10 PPA | 30 | 10 | 14 | 15 | 23 | 0.6 | - | 8.97 | 14.6 | 1.66 | 11 | 15.6 | 3200 | 0.064 | 7-35 days | Available | China | Single box | MONTON |
| NATR 12 | 32 | 12 | 14 | 15 | 25 | 0.6 | - | 6.6 | 8.5 | 0.95 | 7.65 | 10.8 | 4500 | 0.071 | 7-35 days | Available | China | Single box | MONTON |
| NATR 12 PPA | 32 | 12 | 14 | 15 | 25 | 0.6 | - | 6.6 | 8.5 | 0.95 | 7.65 | 10.8 | 4500 | 0.066 | 7-35 days | Available | China | Single box | MONTON |
| NATV 12 | 32 | 12 | 14 | 15 | 25 | 0.6 | - | 9.35 | 15.3 | 1.76 | 10.6 | 15 | 3000 | 0.072 | 7-35 days | Available | China | Single box | MONTON |
| NATV 12 PPA | 32 | 12 | 14 | 15 | 25 | 0.6 | - | 9.35 | 15.3 | 1.76 | 10.6 | 15 | 3000 | 0.069 | 7-35 days | Available | China | Single box | MONTON |
| NATR 15 | 35 | 15 | 18 | 19 | 27.6 | 0.6 | - | 9.52 | 13.7 | 1.56 | 11.4 | 16.3 | 4000 | 0.1 | 7-35 days | Available | China | Single box | MONTON |
| NATR 15 PPA | 35 | 15 | 18 | 19 | 27.6 | 0.6 | - | 9.52 | 13.7 | 1.56 | 11.4 | 16.3 | 4000 | 0.1 | 7-35 days | Available | China | Single box | MONTON |
| NATV 15 | 35 | 15 | 18 | 19 | 27.6 | 0.6 | - | 12.3 | 23.2 | 2.7 | 14.6 | 20.8 | 2600 | 0.11 | 7-35 days | Available | China | Single box | MONTON |
| NATV 15 PPA | 35 | 15 | 18 | 19 | 27.6 | 0.6 | - | 12.3 | 23.2 | 2.7 | 14.6 | 20.8 | 2600 | 0.11 | 7-35 days | Available | China | Single box | MONTON |
| NUTR 15 A | 35 | 15 | 18 | 19 | 20 | 0.6 | 0.3 | 16.8 | 17.6 | 2 | 8.65 | 12.2 | 5000 | 0.1 | 7-35 days | Available | China | Single box | MONTON |
| PWTR 15.2RS | 35 | 15 | 18 | 19 | 20 | 0.6 | 0.3 | 11.9 | 11.4 | 1.2 | 8.65 | 12.5 | 5000 | 0.1 | 7-35 days | Available | China | Single box | MONTON |
| NATR 17 | 40 | 17 | 20 | 21 | 31.5 | 1 | - | 10.5 | 14.6 | 1.73 | 12.5 | 18 | 3400 | 0.14 | 7-35 days | Available | China | Single box | MONTON |
| NATR 17 PPA | 40 | 17 | 20 | 21 | 31.5 | 1 | - | 10.5 | 14.6 | 1.73 | 12.5 | 18 | 3400 | 0.14 | 7-35 days | Available | China | Single box | MONTON |

Track runner bearings

| | | | | | | | | | | | | | | | | | | | | |
|----------------|----|----|----|----|------|---|---|------|------|-----|----|------|------|------|-----------|-----------|-------|------------|--------|--|
| NATV 17 | 40 | 17 | 20 | 21 | 31.5 | 1 | - | 14.2 | 26.5 | 3.1 | 17 | 24.5 | 2200 | 0.15 | 7-35 days | Available | China | Single box | MONTON | |
| NATV 17 PPA | 40 | 17 | 20 | 21 | 31.5 | 1 | - | 14.2 | 26.5 | 3.1 | 17 | 24.5 | 2200 | 0.15 | 7-35 days | Available | China | Single box | MONTON | |